











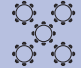

Conference centre floor plans and meeting room capacities

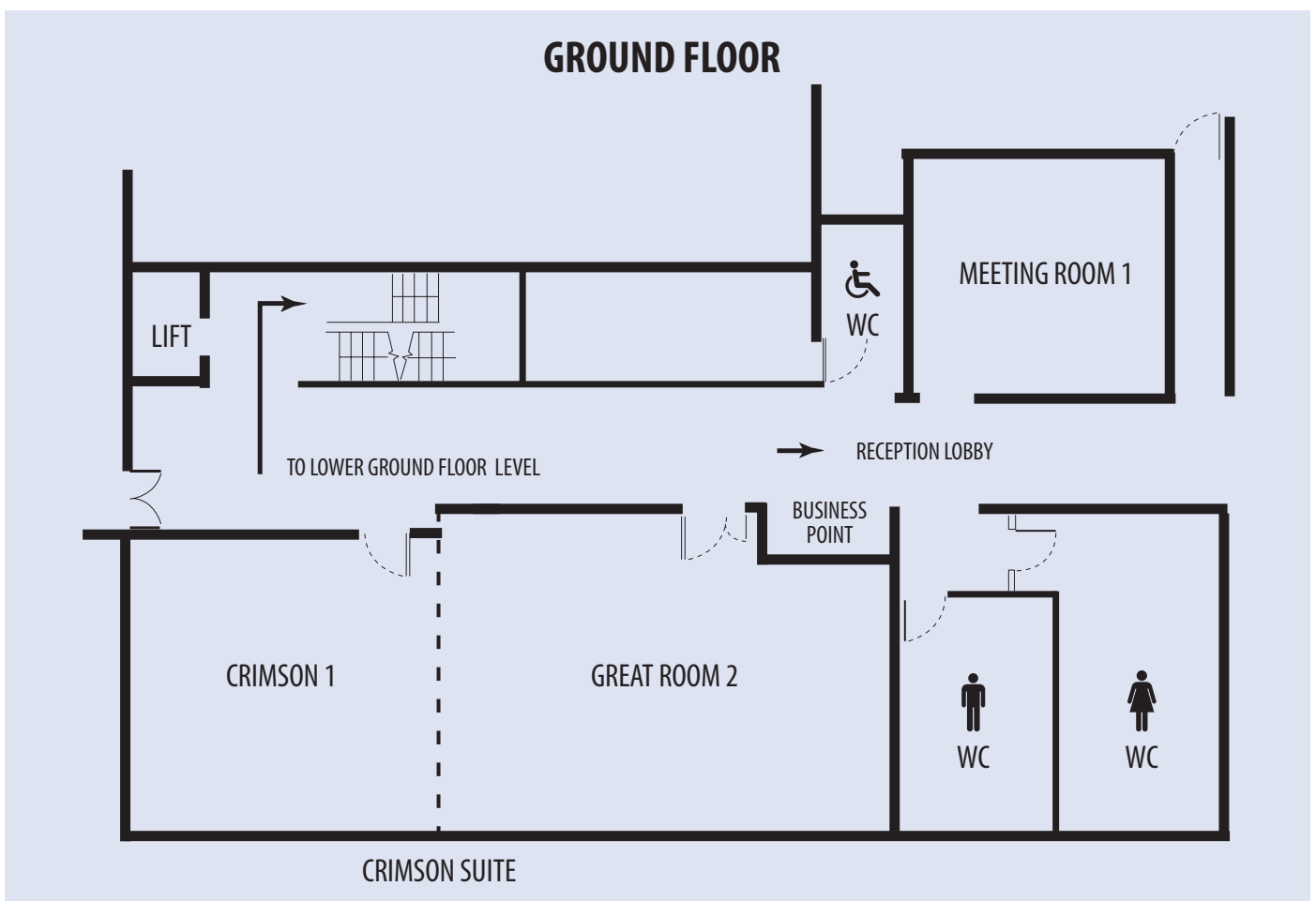
ROOM NUMBER	U-Shape	Classroom Style	Theatre Style	Boardroom	Cabaret	Reception	Dimensions in Mtrs	Area Sq m
								
Meeting Room 1	12	18	24	15	-	-	5.6 x 5.1m	28.5
Great Room 2	25	35	50	30	35	60	10.3 x 6.4m	65.9
Crimson 1	20	28	40	25	20	45	7.1 x 6.8m	48.2
Crimson Suite	-	80	120	-	70	130	17.6 x 6.4m	112.6

Dimensions are approximate

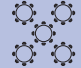

FULLY AIR CONDITIONED ● WIRELESS INTERNET ACCESS ● NATURAL DAYLIGHT

ROOM NUMBER	U-Shape	Classroom Style	Theatre Style	Boardroom	Cabaret	Reception	Dimensions in Mtrs	Area Sq m
								
Meeting Room 5	16	24	32	20	-	-	5.2 x 7.1m	36.9
Meeting Room 6	24	28	45	28	20	-	7.0 x 7.1m	49.7
Meeting Room 7	8	-	-	10	-	-	3.2 x 7.0m	22.4
Meeting Room 8	12	18	24	16	-	-	5.2 x 5.2m	27.0

Dimensions are approximate

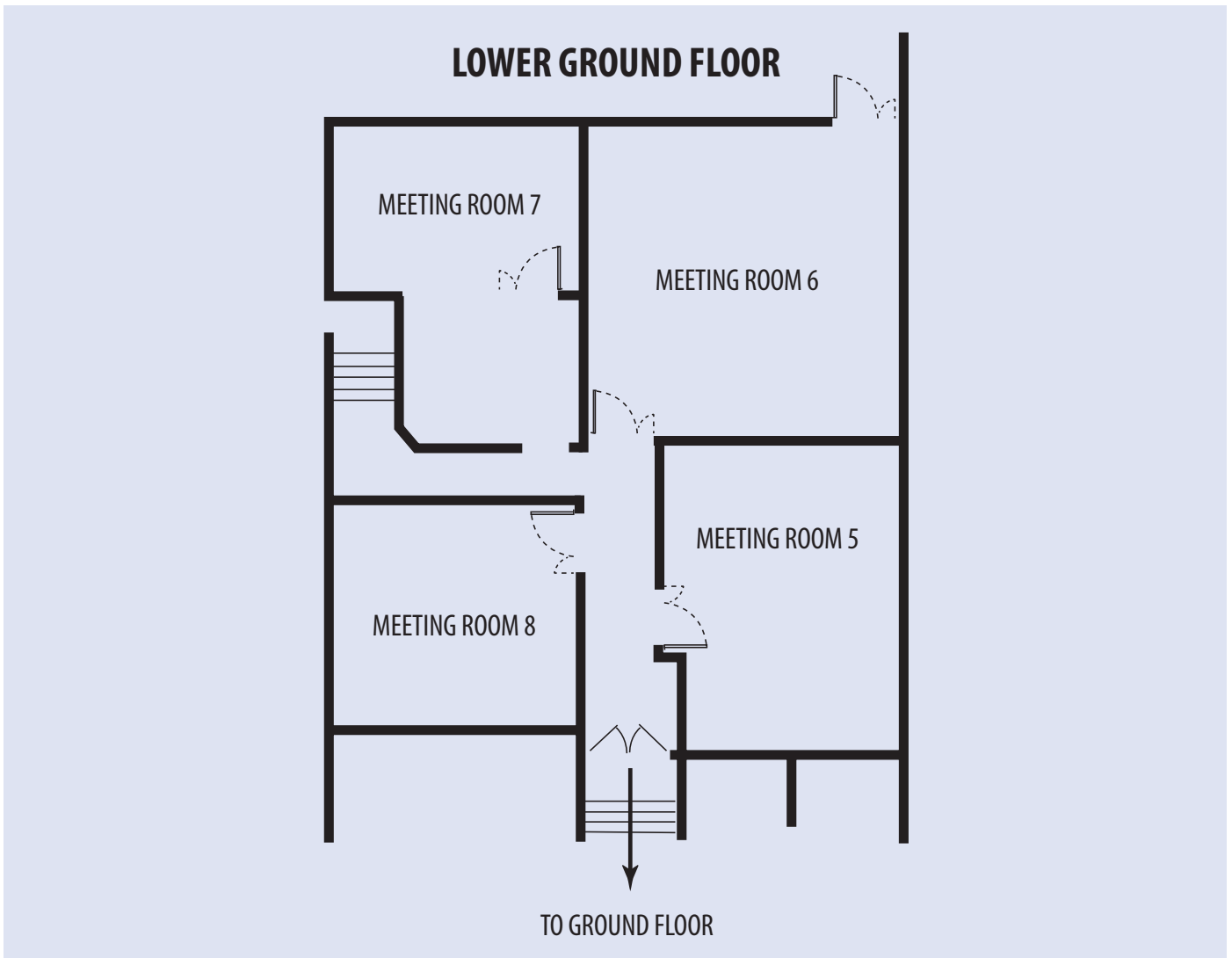

FULLY AIR CONDITIONED ● WIRELESS INTERNET ACCESS ● NATURAL DAYLIGHT